

## Instruction Manual for CMOS Guide Camera VA225C



### Introduction

Thank you for purchasing a Vixen CMOS guide camera VA225C. When you use the product, please also refer to the instructions for your telescope and related equipment.

### Overview

This product is a guide camera designed to monitor star movements and automatically correct equatorial mount operations. This enables long exposure astrophotography with unblurred pinpoint images of stars.

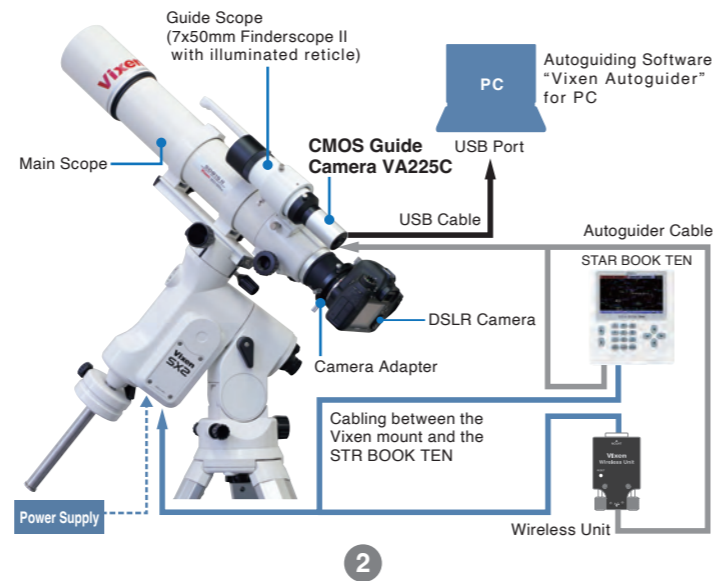

### Safety Precautions

Please read the safety precautions below carefully before using the CMOS Guide Camera VA225C, and do not use it for any purpose other than its intended use. The precautions are for preventing harm to individuals, property damage, and product malfunction.

#### ⚠ WARNING!

Never point this product towards the sun when attached to an astronomical telescope or similar equipment, as this may cause malfunction or fire.

### Cautions

- Do not leave the product inside a car or other places exposed to direct sunlight, as it may cause malfunction.
- Avoid exposure to water, moisture, sand, dust, or corrosive gases, as they may cause malfunction.
- Do not open, disassemble, or modify the product, as it may cause malfunction.
- Do not forcibly bend or pull cables, as this may strain the cable or its connection point and cause damage.
- Do not leave the product in an unstable circumstance when attached to the telescope, as that may cause a fall or drop, leading to malfunction or injury.

### Checking the Package Contents

The VA225C package consists of the following items. Please check to ensure all items are included:



Contents	Q'ty
1 CMOS guide camera VA225C	1
2 31.7mm sleeve	1
3 USB cable	1
4 Autoguider cable	1
5 Instruction manual (This booklet)	1

### Maintenance and Storage

- Attach this product to the instrument in a place of as low humidity as possible.
- When dust adheres to the protective glass surface, blow it off with an airbrush.
- Wipe the body lightly with a soft cloth if dirty. Do not wipe with alcohol, ether, or other strong organic solvents, as it may cause discoloration or deterioration.
- Storing in a humid place may cause malfunction, so store in a well-ventilated place.
- If not used for a long time, stow the product in a plastic bag with a desiccant and seal it.

### Name of Each Part

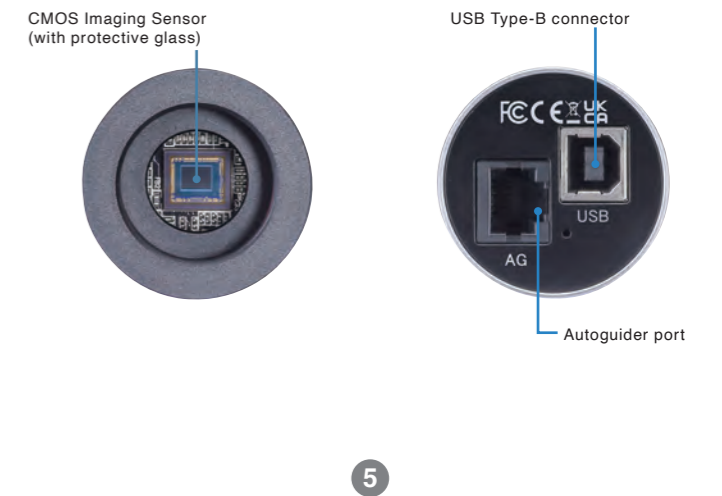

### Attaching to a Guide Scope

This manual uses the 7x50mm finderscope II with illuminated reticle as an example of a guide scope. We recommend using it with a Vixen 50mm low-profile finder bracket II (S).

1 Loosen the fixing screws on the side of the finderscope tube holding the eyepiece unit to separate the eyepiece unit part.

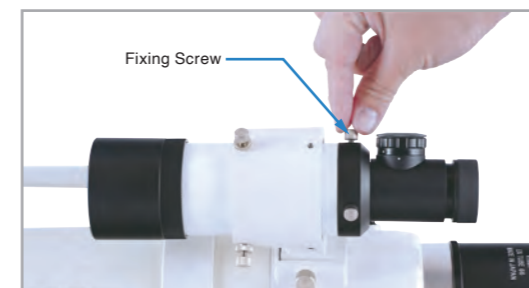

2 Attach the supplied 31.7mm eyepiece sleeve to the VA225C and insert it in place of the eyepiece unit. Tighten the fixing screws securely to complete the installation.

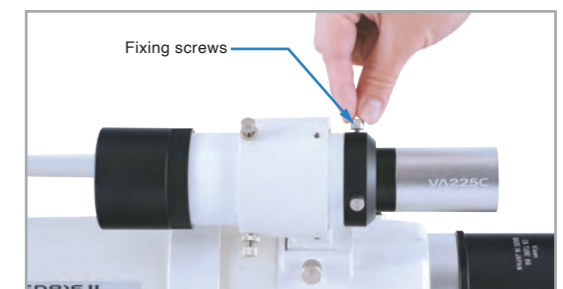

## Connecting Cables

This is shown using the Wireless Unit as an example.

- 1 Of the cables supplied, plug the cable with the USB Type-B connector to the VA225C and the USB Type-A connector on the other side of the same cable to the PC.

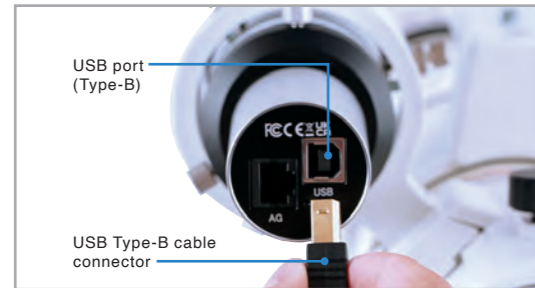

8

- 2 Plug one end of the connector of the autoguider cable to the VA225C and the other end to the autoguider port of the Wireless Unit.

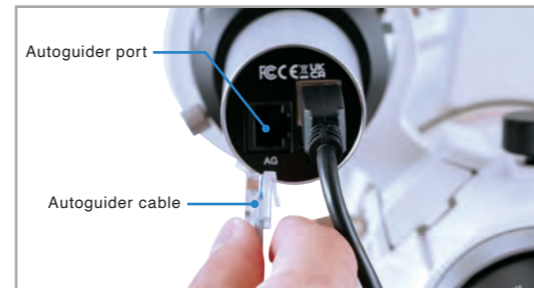

9

## Downloading "Vixen Autoguider" software

- Visit the Vixen webpage and download "Vixen Autoguider" autoguiding software from the product webpage below for the CMOS guide camera VA225C, and install this dedicated software on your PC.

<https://www.vixen.co.jp/software/autoguider/>



OS: Windows 7, 8, 10, 11

Basic operation of the "Vixen Autoguider" autoguiding software is available from the software download page on the Vixen website.

10

## Dimensions

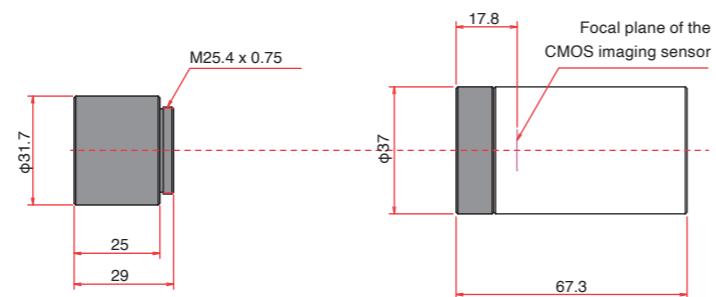

## Specifications

Image Sensor	SONY IMX225 (1/3-inch color CMOS imaging sensor)
Pixel Size	3.75μm X 3.75μm
Effective Pixels	Approximately 1.2 million pixels
Autoguider Port	6-pole 6-core modular jack
USB Port	USB Type-B
Supported OS	Windows 7, 8, 10, 11
Power Supply	USB 2.0 (supplied by a PC side)
Size	37mm dia. × 92 mm long
Weigh	100 g
Accessories	Autoguider cable, USB cable

11